

INFO-PACK



Location of Project:

ELITE HOMZ
Sector-77, Noida
Ph.: +91 9650673388

FOR BOOKING CALL

=====

Sales Team: +91-9650973388
 +91-9560473388
GM Sales: +91-9958333766

About Elite Homz:

HR Oracle Developers is a joint venture between H.R. Buildxon (P) Ltd. And Oracle Realtech (P) Ltd. Both these companies have been in the realty sector for a long time now. And during their respective operation in the industry they have gathered years of valuable experience that goes into the making of HR Oracle Developers. With their combined experience, principles, and innovative architectural approach, they are bringing forth a mega housing project under the name Elite Homz at Sec-77, Noida

Features:

- ❖ More than 75% open area
- ❖ Entrance Lobbies in each block
- ❖ Each Flats is a corner flat
- ❖ Vaastu & Eco friendly layout
- ❖ Grand entrance through lush
- ❖ AC Party Hall
- ❖ 24 Hr water supply

Recreation

- ❖ Swimming pool with separate kids pool
- ❖ Well developed landscaped garden
- ❖ A.C. Gymnasium,
- ❖ Library
- ❖ Indoor Games:
- ❖ Outdoor Games

Layout Plan

Layout Plan



LEGEND

1. Grand Entrance
2. Fountain Plaza
3. Landscaped Greens
4. Half Basketball Court
5. Jogging Track
6. Skating Rink
7. Manicured Green
8. Kids Play Area
9. Amphitheatre
10. Drop Off
11. Net Cricket
12. Badminton Court
13. Swimming Pool & Kids Pool
14. Elite Club
15. Ramps
16. Plaza With Seating
17. Parking
18. Palm Plaza
19. Commercial

TYPE I - 1295 & 1317 SQ. FT.
 TYPE II - 1555 & 1564 SQ. FT.
 TYPE III - 1830 SQ. FT.
 TYPE IV - 2217 SQ. FT.

Floor Plan.



TYPE - 1 A

- 2 BEDROOMS
- 2 TOILETS
- LIVING ROOM
- DINING ROOM
- KITCHEN
- BALCONIES

SUPER AREA 1115 SQ. FT

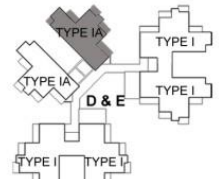

KEY PLAN



TYPE - 1

- 2 BEDROOMS
- 2 TOILETS
- LIVING ROOM
- DINING ROOM
- KITCHEN
- STUDY ROOM
- BALCONIES

SUPER AREA 1295 SQ. FT

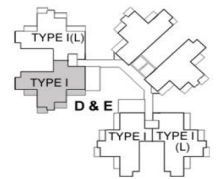

KEY PLAN

Floor Plan.



TYPE - II

- 3 BEDROOMS
- 2 TOILETS + DRESS ROOM
- LIVING ROOM
- DINING ROOM
- KITCHEN
- BALCONIES

SUPER AREA 1555 SQ. FT.

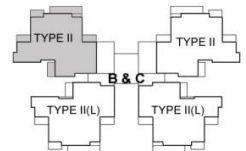

KEY PLAN



TYPE - I

- 2 BEDROOMS
- 2 TOILETS
- LIVING ROOM
- DINING ROOM
- KITCHEN
- STUDY ROOM
- FOYER
- BALCONIES

SUPER AREA 1317 SQ. FT.

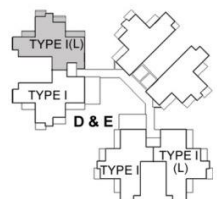

KEY PLAN

Floor Plan.



TYPE - III

- 3 BEDROOMS
- 3 TOILETS + DRESS ROOM
- LIVING ROOM
- DINING ROOM
- KITCHEN
- STUDY ROOM
- STORE
- BALCONIES

SUPER AREA 1830 SQ. FT.

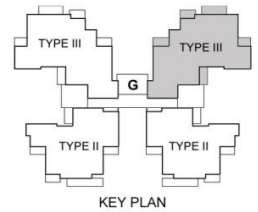

TYPE - II

- 3 BEDROOMS
- 2 TOILETS + DRESS ROOM
- LIVING ROOM
- DINING ROOM
- KITCHEN
- FOYER
- BALCONIES

SUPER AREA 1564 SQ. FT.

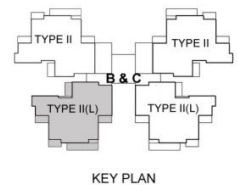

Floor Plan.



TYPE - IV

- 4 BEDROOM
- 4 TOILETS
- LIVING ROOM
- DINING WITH FAMILY LOUNGE
- KITCHEN
- SERVANT ROOM
- BALCONIES

SUPER AREA 2217 SQ. FT.

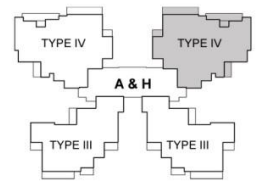

KEY PLAN

LOCATION MAP



MAP NOT TO SCALE