



Logix Group
The life you deserve

INFO-PACK

Location of Project:

Sec-143 Noida

Ph.: +91 9650673388

FOR BOOKING CALL

=====
Sales Team:+91-9650973388

+91-9560473388

GM Sales: +91-9958333766

CHANNEL PARTNER:

=====
FSI MARKETING LTD.PVT.

403c Ocean Plaza P-5 Sec-18 Noida

Phone No-0120-4212953-57

Email-sales@fsimarketing.in



Overview :

Welcome to the vivacious world of Blossom Zest.

Live young. Live free. Live spirited. After the overwhelming response to Blossom County and Blossom Greens, Logix plans to bring another well designed residential complex, Blossom Zest. The project is located in sector-143 adjacent to Blossom Greens. Two side open plot, the site is spread over 25 acres and the complex is designed to have studio, 2, 3 & 4 BHK apartments and penthouses

SPECIFICATIONS:

EXTERNAL FACEDE :

- Combination of Stone Work in Dado & Superior Texture Paint on All Floors.

FLOORING:

- High quality Vitrified tiles in Drawing/Dinning/Bedrooms.
- European laminated wooden flooring in master bedrooms.
- Branded Anti-Skid ceramic tiles in toilets and Balcony

DOORS & WINDOWS:

- Granite counter top, Ceramic Glazed tiles on wall, flooring of branded Anti-Skid ceramic tiles & Stainless steel sink.

TOILET:

- Branded Anti-Skid Ceramic Floor tiles, Ceramic tiles upto 7 feet, kajaria/Somany or Equivalents.
- Sanitary Ware: hindware, Cera/Equivalent, Fittings: Jaquar/ Equivalent for 2 BHK.

ELECTRICAL:

- Copper wiring in Concealed PVC Conduits.
- Sufficient Light and Power points .
- Provision for Tv, Telephone points.
- AC points in all rooms.

INSIDE WALL & FINISHES:

- Drawing/Dinning with Plastic paints and all other internal wall with.



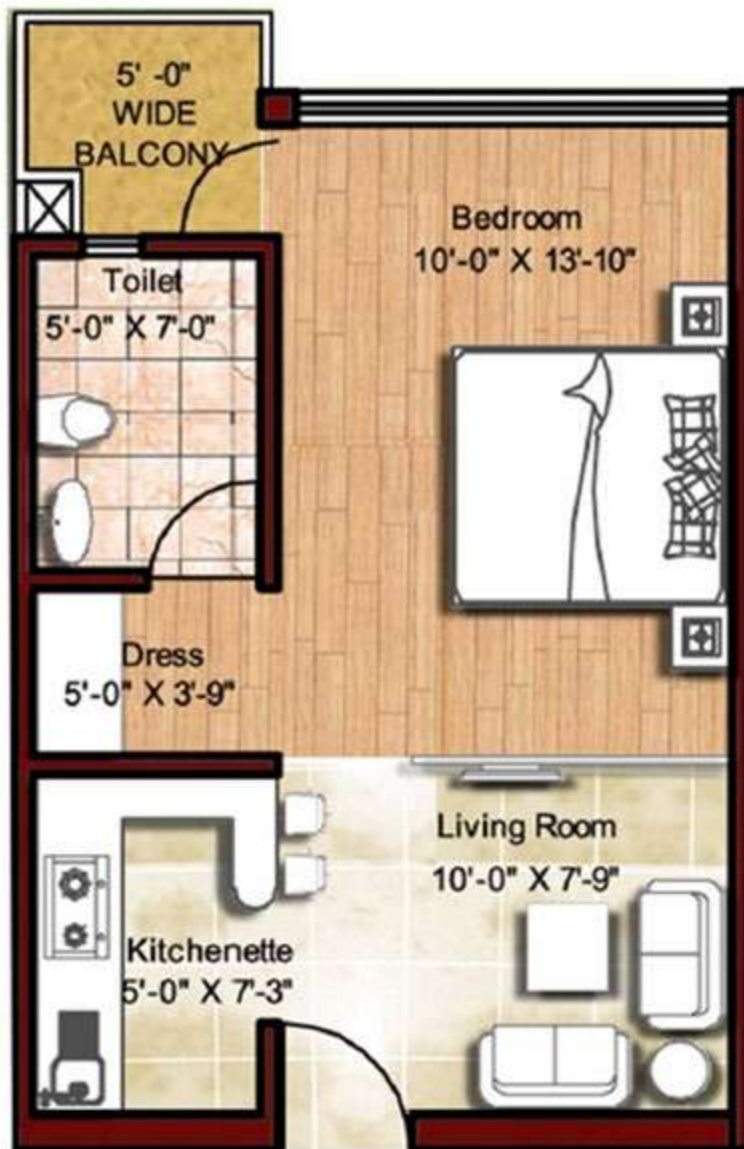

Logix Group
The life you deserve

**SALEABLE AREA:
470 SQ.FT.**

1BHK STUDIO APARTMENTS
TYPICAL UNIT PLAN



Logix Group
The life you deserve



SALEABLE AREA:
840 SQ.FT.

2BHK APARTMENTS
TYPE A - TYPICAL UNIT PLAN



SALEABLE AREA:
875 SQ.FT.

2BHK APARTMENTS
TYPE B - TYPICAL UNIT PLAN

2BHK APARTMENTS
(CLUSTER PLAN)





Price List:

PREMIUM 1BHK STUDIO APARTMENTS

PRICE-LIST

(w.e.f. – 16-05-2011)

BASIC SALE PRICE	:	Rs. 2990/- psf
INAUGURAL DISCOUNT	:	Rs. 1 lac (Limited Period Offer only for Studio)

Additional Charges

INTERNAL DEVELOPMENT CHARGES	Rs.75/-psf
EXTERNAL DEVELOPMENT CHARGES	Rs. 75/-psf
ELECTRIC SUB STATION CHARGES	Rs. 40/-psf
CLUB MEMBERSHIP	Rs.1,00,000/-
COMPULSARY CAR PARKING SPACE(ONE)	Rs. 2,50,000/-
ONE TIME LEASE RENT	Rs. 100/- psf
INTEREST FREE MAINTENANCE SECURITY	Rs. 100/- psf

Preferential Location Charges;

Ground Floor to 5 th Floor	Rs. 100/- psf	6 th floor to 10 th floor	Rs. 60/- psf
Inner Green Facing	Rs. 100/- psf	Outer Green Facing	Rs. 25/- psf



Price List:

Terms :

- ❖ Cheque/Draft are to be made in favour of **M/s Logix City Developer Pvt. Ltd.** payable at Noida/Delhi.
- ❖ Registry Exp., Stamp duty & other applicable government & statutory levies, if any, will be charged extra & to be Borne by the customer.
- ❖ Pricelist and payment plans can be changed without notice at the sole discretion of the company. However **there shall be no escalation for the booked flats.**
- ❖ Areas can be subject to change as per Architectural drawings.
- ❖ **Timely payment of installments is the essence of agreement.**
- ❖ Company is fully authorized for final acceptance or rejection of application form.
- ❖ The above installment plan shall become payable on demand irrespective of the order in which they are listed.
- ❖ The first transfer is free of charge & would be allowed only after 30% of the payment has been received. However in case of family transfer minimum condition of 30 % would not be applicable subject to proof of relationship.
- ❖ Inaugural Discount of Rs. 1 lac on 1 bedroom Studio Apartment would be adjusted against CAR PARKING Charges
- ❖ Service tax as applicable would be charged extra.



Payment Plan

Plan-A (Construction Linked Plan)

S.No.	Particulars	Installment
1	On Application of Booking	As applicable
2	45 Days or on Agreement	20% less Booking Amount
3	45 Days from Agreement or PCC	10%
4	On Completion of 1st Floor	10%
5	On Completion of 4th Floor	8%+car parking space charges
6	On Completion of 7th Floor	8% + EDC
7	On Completion of 10th Floor	8% + IDC
8	On Completion of 13th Floor	8% + PLC as applicable
9	On Completion of Top Floor	8% + Electric Sub Station Charges
10	Plaster + Brick Work	8%
11	Plumbing + Finishing	7%
12	Possession	5% +Club Membership+ IFMS+ Lease rent

Plan-B (Flexi Plan) Discount : @ 7% on BSP

S.No.	Particulars	Installment
1	On Application of Booking	As applicable
2	60 Days from Booking	45% less Booking Amount
3	On Completion of foundation	10%+Car Parking space
4	On Completion of basement Slab	10%+ EDC
5	On Completion of 5th Floor Slab	10%+IDC
6	On Completion of 8th Floor Slab	10% + PLC as applicable
7	On Completion of 13th Floor slab	10% + Electric Sub Station Charges
8.	At the time of offer of possession	5% +Club Membership+ IFMS+ Lease rent



Payment Plan

Plan-C (Down Payment Plan)
Discount : @ 12% on BSP

S.no.	Particulars	Installment
1	Booking Amount	As applicable
2	30 Days from Booking	95% less booking amount +EDC+ IDC+Car Park+Electric Sub Station Charges +PLC as applicable
3	At the Time of offer of Possession	5% +Club Membership+ IFMS+Lease Rent

Booking Amount

1BHK Studio Rs. 1,50,000/-